

Panasonic
BUSINESS

Digital Communication Terminal
KX-DTU100

Seamless
Voice Communication



Ease of use & peace of thanks to 2-way commu

Would you like to improve work efficiency at your assisted living facility by communicating

The Panasonic KX-DTU100 is a Digital Communication Terminal that provides rapid but smooth communication in the assisted combination with the Panasonic communication system to enable smooth and high quality communication between residents

High Quality and Usability



Natural Communication

Thanks to the full duplex speakerphone, overlapping conversations no longer result in jarring interruptions, allowing for natural conversations. This allows for smooth communication.



Large and Visible Call Button

A prominent red call button is equipped to the white body to offer excellent visibility and operability. In addition, the always-on LED light provides convenience and visibility even at night.



One Touch Button

In addition to the call button, the device is outfitted with 3 one touch buttons. The one touch buttons can be used as a simple speed-dial function, as well as playback recordings about activity information and listening to recorded food and drink menus. The one touch button operation enables smooth and effective communication solutions for assisted living facilities.



Adjustable Volume

The Speakerphone volume is adjustable over 4 levels. An easy-to-operate volume adjustment button has been adopted to enable easy operation for the elderly and is situated in a visible location on the front of the device.



Supports External Device Connectivity

The devices listed below can be connected to provide further expanded capabilities depending on the needs of the assisted living facility and residents.

- Panasonic Digital Proprietary Telephone KX-DT500 series, Single Line Telephone* or KX-DTU100
- Call Cord (1/4-inch pin cord)
- Pull Switch (2-pin AWG26-AWG20 cable)

*Requires DHLC card installed in the PBX unit.

mind nication

smoothly and effectively?

living facility. It provides a call system in
and caregivers.



Easy Administration, Programming and Maintenance



**Centralized
Management**

There is no need to set up each terminal individually for the KX-DTU100 as centralized programming is possible through the PBX. Installation and maintenance is easier while reducing operation costs and man-hours. In addition, in the unlikely case that the unit breaks down, the original operating environment can be restored by simply replacing the device, enabling infrastructure recovery in a short period of time.



Battery-less

The main power source is provided by the PBX unit, eliminating the need for not only separate construction work, but concern over battery lifespan and replacement.



Easy to Clean

Button text will never fade or disappear when cleaning or wiping thanks to acrylic coating allowing the device to be frequently cleaned before and after use.

Functions

Front Side

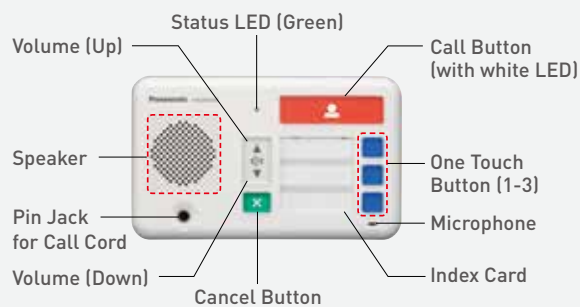

Rear Side

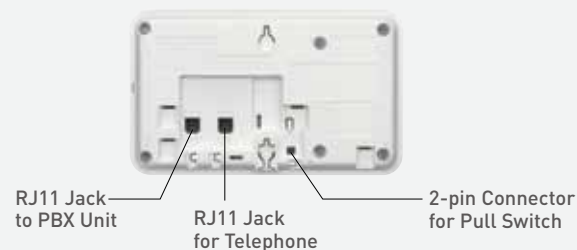

Selectable Installation Styles

The KX-DTU100 supports both desk placement using a stand and wall mounting. In addition, the device can be installed by simply plugging in the cord from the PBX, eliminating the need for complicated construction work.

Wall mounting



Placed on a desk

System Connection Diagram

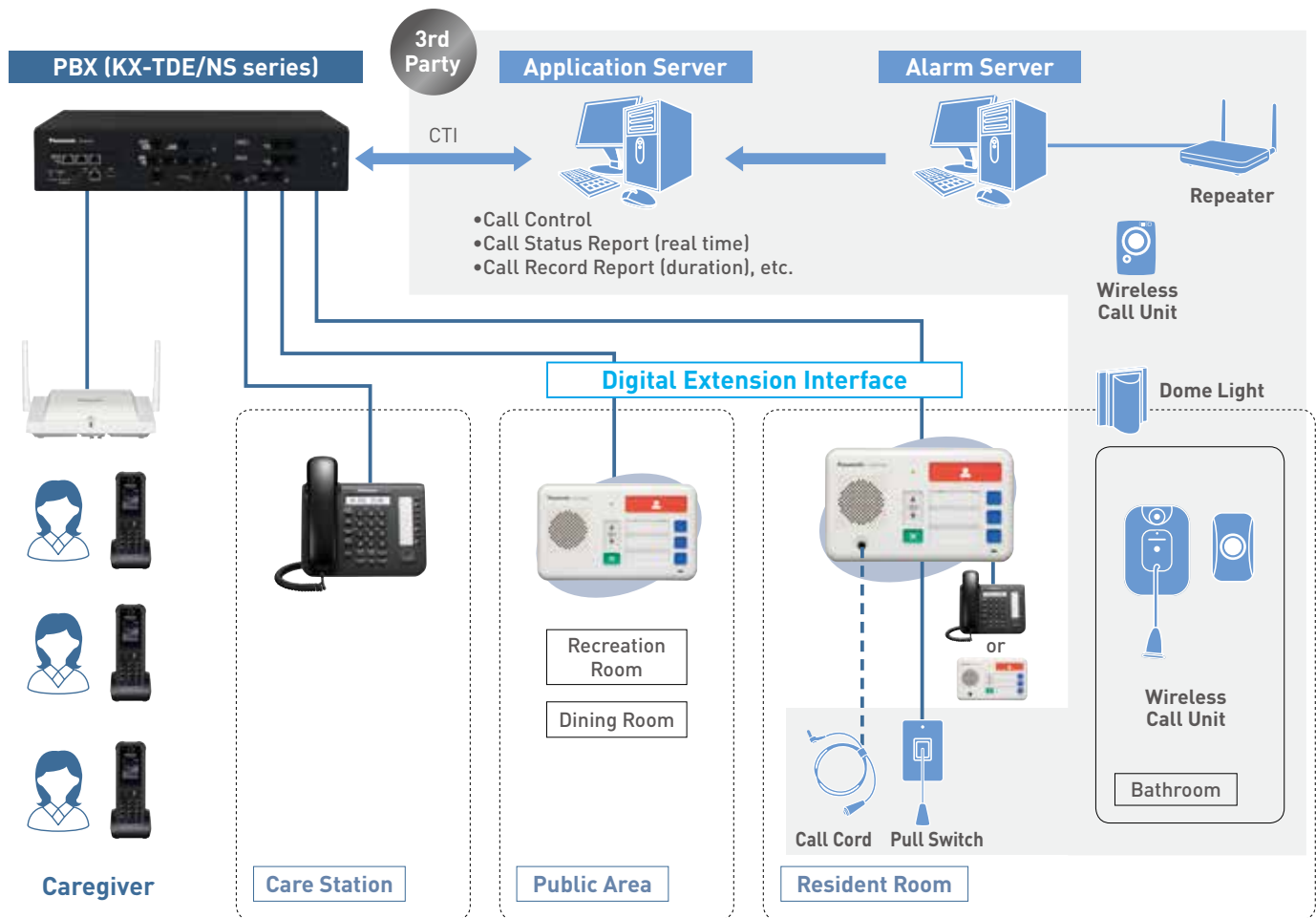

Specifications

Items	Specification	
Compatible PBX	KX-TDE600/200/100, KX-NS700, KX-NS1000 with Legacy Gateway	
Speakerphone	Full Duplex (Volume Control: 4 steps)	
External Expansion	DXP port (DHLC XDP is available)	
Optional Interface	Front side: 1/4-inch jack (2-pin) for call cord Rear side: 2-pin connector (AWG26-AWG20) for pull switch	
Dimension	205 mm (W) x 46 mm (D) x 124 mm (H)	
Weight	Approx. 500 g (main unit only) / Approx. 620 g (including stand)	
Standards	EMC	FCC 15B, ICES-003
	Safety	UL 60950-1, CSA60950-1
Operating Temperature	0°C to 40°C	
Operating Humidity	10% to 90% (non-condensing)	

Important

- Safety Precaution: carefully read the Quick Reference Guide before using these products.

- Weights and dimensions are approximate.
- Design and specification subject to change without notice.
- This product may be subject to export control regulations.

1.800.635.3587
business.panasonic.ca

Panasonic
BUSINESS