

U-36PE1U6  
OUTDOOR UNIT

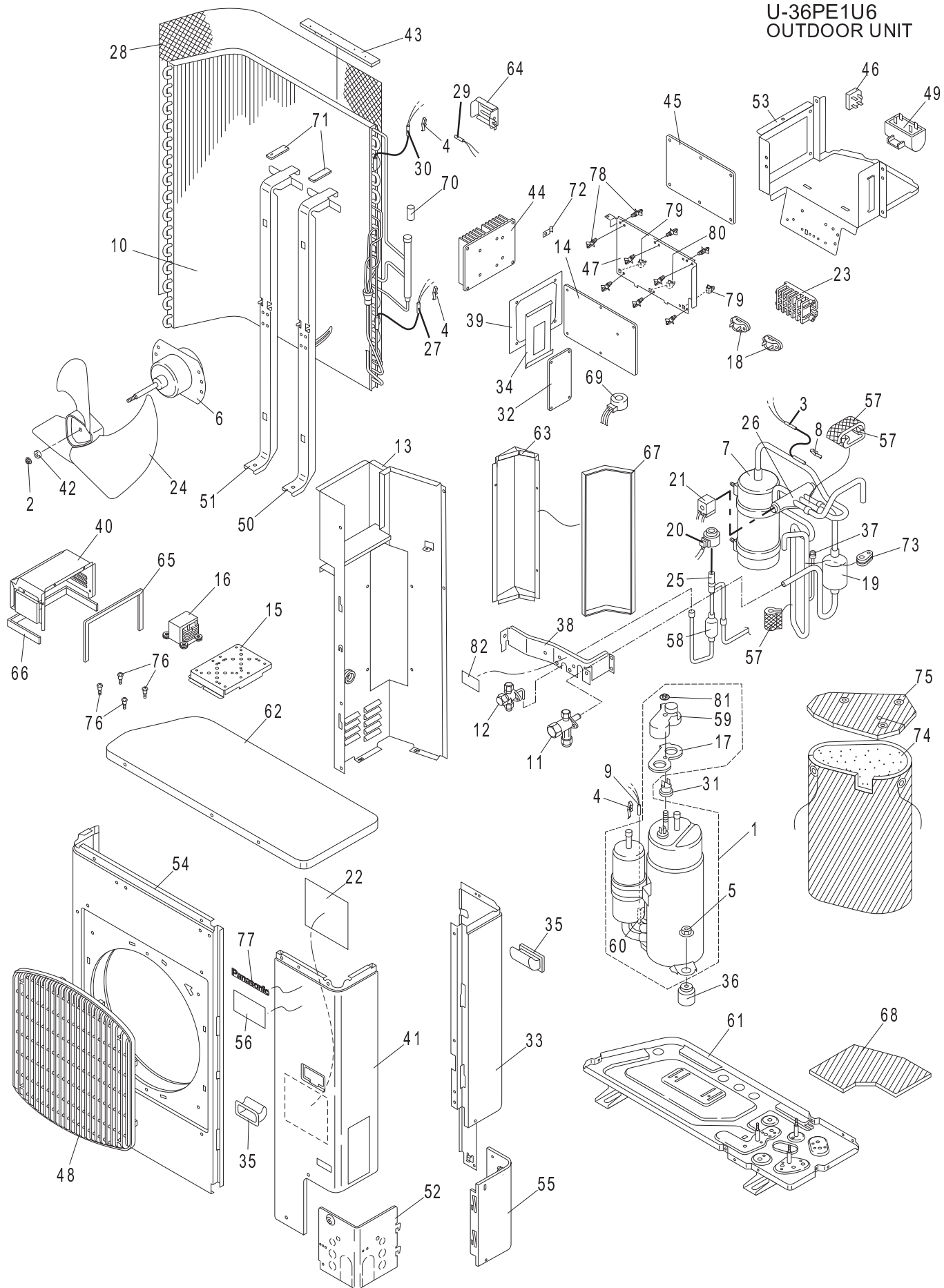

# ATTENTION!

To ensure correct parts supply, please let us know the following,

Part No. when you make service parts order:

1.Part No. 2.Description 3.Q'ty 4.Volts-Hz-Ph 5.Product Mode No.

U-36PE1U6  
OUTDOOR UNIT

KeyNo.	Part No.	Description	Model Number	Q'ty	Reference No.
* 1	CV 6231843171	Compressor Ass'y(INV)	C-7RVN153H0U	1	8540452530000
2	CV 6380126705	Domed Cap Nuts		1	3927506010
* 3	CV 6231811897	Thermistor(TS)	DTN-C532G3H-TKS2	1	1FA4V2E030500
4	CV 6231485876	Mounting Thermostat		3	8522530322401
5	CV 6230296497	Nut Special Ass'y		3	8510239510201
* 6	CV 6231915717	Fan Motor	DAJ12-95B61A-CR	1	1FA4M4A012000
7	CV 6233189840	Accumulator Ass'y		1	8540451750200
8	CV 6231696487	Mounting Thermostat		1	8522530324801
* 9	CV 6231664141	Thermistor(TD)	DTNC583G3UTKS236	1	1FA4V2E012000
* 10	CV 6231812283	Heat Exch Ass'y		1	8540412449100
11	CV 6231811965	Valve Ass'y 5/8 in.		1	8540450628500
12	CV 6231811958	Valve Ass'y 3/8 in.		1	8540450432300
13	CV 6231915755	Partition Plate Ass'y		1	85402516321H2
* 14	CV 6231921909	Controller Ass'y	CR-CH4872R	1	8549953605286
15	CV 6231811927	Mounting Plate		1	8542236196301
* 16	CV 6231812269	Reactor	R502AH14-T23	1	1FA4L5C011900
17	CV 6260401007	Gasket Terminal		1	8012530314200
18	CV 6231407595	Clip Wire		2	8522530416700
19	CV 6231849555	Muffler		1	8542451912800
* 20	CV 6231715874	Magnetic Coil(MOV)	UKV-U013E	1	1FA4L8A019700
* 21	CV 6231915779	Magnetic Coil Ass'y(20S)	STF-01AQ503UA1	1	8FA0525117600
22	CV 6231916042	Elec. Wiring Diagram		1	8FA2525771800
* 23	CV 6233027265	Terminal Base	HP-T3041-E2C6-L2	1	1FA4J3A030000
24	CV 6231736893	Propeller Fan Ass'y		1	8542253910610
* 25	CV 6231704267	Solenoid Control Valve	UKV-18D13	1	8542454815000
* 26	CV 6231915809	Reversing Valve	STF-02U2G	1	8542450819000
* 27	CV 6231664660	Thermistor(C1)	DTNC532G3HTKS232	1	1FA4V2E012100
28	CV 6231812047	Guard		1	8542111327500
* 29	CV 6231664233	Thermistor(TO)	DTNC532G3HTKS238	1	1FA4V2E011600
* 30	CV 6231812030	Thermistor(C2)	PB2M-41E-S1	1	1FA4V2E030300
* 31	CV 6231915793	Thermostat(OLR)	CS-7L110	1	4233960062
* 32	CV 6231921916	P.C.B. Ass'y	HIC-CH2672R	1	8549953605288
33	CV 6231915854	Rear Panel		1	85421103366H2
34	CV 6231915847	Sheet		1	1FA4G1A008900
35	CV 6231812115	Knob		2	85421311131H1
36	CV 6231056106	Cushion Rubber		3	8512239015600
* 37	CV 6231915830	Switch Ass'y(63PH)	ACB-4UB3002W	1	8FA0525703700
38	CV 6231812092	Support valve		1	8542412932501
39	CV 6231915823	Sheet		1	1FA4G1A008800
40	CV 6231812078	Mounting Plate Ass'y		1	8540232368701

NOTE: Metal and plastic parts will be supplied basically with necessary heat insulation pads or packing. Each key number with an asterisk (\*) means the recommended service parts.

# ATTENTION!

To ensure correct parts supply, please let us know the following,

Part No. when you make service parts order:

1.Part No. 2.Description 3.Q'ty 4.Volts-Hz-Ph 5.Product Mode No.

U-36PE1U6  
OUTDOOR UNIT

KeyNo.	Part No.	Description	Model Number	Q'ty	Reference No.	
41	CV 6231915892	Front Panel		1	85421116192H5	
42	CV 6230954960	Washer Special		1	8542135513300	
43	CV 6380194452	Packing		1	8542236651900	
44	CV 6231915885	Cooler		1	8542532519301	
*	45	CV 6231921923	P.C.B. Ass'y	FIL-CH4872R	1	8549953605287
*	46	CV 4070037003	Diode	DBA250G	1	DDDBA250G---N
47	CV 6231812023	Elec. Component Box		1	8542530625901	
48	CV 6231915861	Guard		1	8542111321912	
*	49	CV 6231812320	Fixed Capacitor	RU23B406R2396X	1	1FA4C1A009200
50	CV 6231812313	Base Ass'y, Fan Motor		1	8540250721301	
51	CV 6231812306	Support Fan Motor		1	8542251638601	
52	CV 6233135168	Cover Plate		1	8542234287423	
53	CV 6231812016	Elec. Component Box Ass'y		1	8540531101601	
54	CV 6231915922	Front Panel		1	8542111619112	
55	CV 6233135175	Cover Plate		1	8542113343223	
56	CV 6233189857	Badge		1	8542135433500	
57	CV 6230529359	Vibration Insulation		3	8522247515400	
58	CV 6231018968	Strainer Ass'y		1	8540452213100	
59	CV 6230957985	Cover Terminal		1	8012619413400	
60	CV 6231250184	Mounting Thermostat		1	8522530317700	
61	CV 6233189864	Bottom Plate Ass'y		1	8540220458803	
62	CV 6231915984	Top Panel		1	85421112394H3	
63	CV 6231812252	Mounting Plate Ass'y		1	8540232368601	
64	CV 6231915960	Mounting Plate		1	8542530922411	
65	CV 6231921947	Packing		1	8542236671710	
66	CV 6231921930	Packing		1	8542236672310	
67	CV 6231812962	Packing		1	8542236671600	
68	CV 6231693585	Sound Insulation Compressor		1	8542242225800	
*	69	CV 6231916011	Transformer Ass'y	CL-9	1	8FA0526304400
70	CV 6231708364	Insulation Special		1	8542241133100	
71	CV 6231885447	Packing		2	8542236670300	
72	CV 6231916004	Mounting Plate		1	8542236206801	
73	CV 6231916035	Protection Rubber		1	8542235618300	
74	CV 6231812221	Sound Insulation Compressor		1	8542242235100	
75	CV 6231812108	Sound Insulation Compressor		1	8542242235000	
76	CV 6231638074	Screw Special		4	8522239615401	
77	CV 6233162478	Badge		1	8542135433001	
78	CV 6230971677	Spacer	SPLSN-6	9	8512536603800	
79	CV 6230964068	Spacer	#6 16	2	8512536603300	
80	CV 6231927949	Spacer	2196	1	8512536607600	

NOTE: Metal and plastic parts will be supplied basically with necessary heat insulation pads or packing. Each key number with an asterisk (\*) means the recommended service parts.

## ATTENTION!

To ensure correct parts supply, please let us know the following,

Part No. when you make service parts order:

U-36PE1U6  
OUTDOOR UNIT

1.Part No. 2.Description 3.Q'ty 4.Volts-Hz-Ph 5.Product Mode No.

KeyNo.	Part No.	Description	Model Number	Q'ty	Reference No.
81	CV 6260400888	Nut 5mm		1	8012830510100
82	CV 6233193526	Caution Label		1	8546575950500
	CV 6233186900	Operation Manual		1	8546460916302
	CV 6233186979	Installation Instructions		1	8546436953102

NOTE: Metal and plastic parts will be supplied basically with necessary heat insulation pads or packing.  
Each key number with an asterisk (\*) means the recommended service parts.