

# Panasonic®

## Installation Manual

Powered by  
delkathree, Inc. **joip™**

Global VoIP Telephone Cordless Handset

Model No. **BB-GTA150**

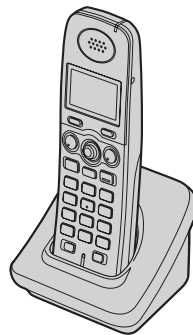

**5.8GHz**  
DIGITAL CORDLESS PHONE

**GLOBARANGE**  
globarange.com

**Thank you for purchasing a Panasonic cordless telephone.**

This handset is an accessory handset for use with Panasonic base units BB-GT1500/BB-GT1540. You must register this handset with your base unit before it can be used.

This installation manual describes only the steps needed to register and begin using the handset. Please read the base unit's operating instructions for further details.

**Charge the battery for 7 hours before initial use.**

Please read this Installation Manual before using the unit and save for future reference.



\*GTA150\*

**PQQX15951ZA** DM0507SH0

## Accessory information

### Included accessories

Accessory item	Order number	Quantity
Charger	PQLV30054PB	1
AC adaptor for charger	PQLV208	1
Battery	HHR-P107	1
Handset cover* <sup>1</sup>	PQYNGTA150BR	1
Belt clip	PQKE10478Z2	1

\*1 The handset cover comes attached to the handset.

### Sales and support information

- To order replacement accessories, call 1-800-332-5368.
- TTY users (hearing or speech impaired users) can call 1-866-605-1277.

## Setting up the handset

### Connecting the charger

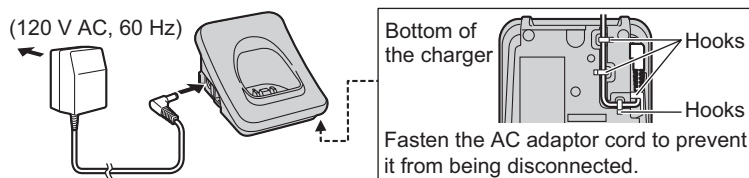

#### Note:

- Use only the included Panasonic AC adaptor PQLV208.
- The AC adaptor must remain connected at all times. (It is normal for the adaptor to feel warm during use.)
- The AC adaptor should be connected to a vertically oriented or floor-mounted AC outlet. Do not connect the AC adaptor to a ceiling-mounted AC outlet, as the weight of the adaptor may cause it to become disconnected.

### Battery installation

- 1 Press the notch of the handset cover firmly, and slide it in the direction of the arrow.

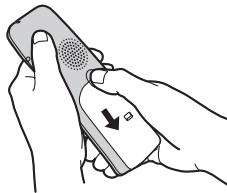

- 2 Insert the battery (1), and press it down until it snaps into position (2). Then close the handset cover (3), (4).

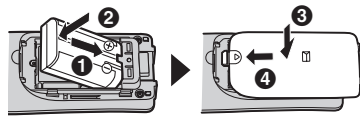

**Attention:**



A nickel metal hydride battery that is recyclable powers the product you have purchased. Please call 1-800-8-BATTERY (1-800-822-8837) for information on how to recycle this battery.

### Battery charge

Place the handset on the charger for **7 hours** before initial use.

- While charging, the charge indicator on the handset lights in amber. When the battery is fully charged, the indicator lights in green.

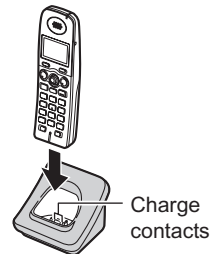

**Note:**

- If you want to use the handset immediately, charge the battery for at least 15 minutes.
- To ensure that the battery charges properly, clean the charge contacts of the handset and charger with a soft, dry cloth once a month. Clean more often if the unit is subject to the exposure of grease, dust, or high humidity.

**Panasonic battery performance**

Operation	Operating time
While in use (talking)	Up to 6 hours
While not in use (standby)	Up to 14 days
While using the clarity booster feature	Up to 4 hours

**Note:**

- The handset can be left on the charger without any ill effect on the battery.
- The battery level may not be displayed correctly after you replace the battery. In this case, place the handset on the charger and let it charge for 7 hours.

**Registration**

Register the handset to a BB-GT1500/BB-GT1540 base unit.

**1 Base unit:****BB-GT1500**

Press and hold **[HANDSET LOCATOR]** until the STATUS indicator flashes in red.

**BB-GT1540**

Press and hold **[LOCATOR]** until the registration tone sounds and the STATUS indicator flashes in red.

- If all registered handsets start ringing, stop ringing by pressing the same button. Then repeat this step.
- After the STATUS indicator starts flashing in red, the rest of the procedure must be completed within 90 seconds.

**2 Handset:****[OK↵]**

- When the handset has been registered successfully, **☑** will change to **☒**.

**Changing the display language**

- [OFF] → [MENU] → [⊕][1][1][0]**
- [↕]/[▲]**: Select the desired setting.
- Press down the center of the joystick to save. → **[OFF]**

## Belt clip

You can hang the handset on your belt or pocket using the included belt clip.

### To attach the belt clip

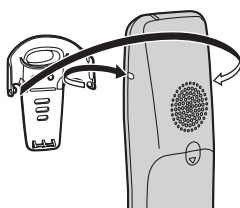

### To remove the belt clip

While pressing the top of the clip (1), pull the right edge in the direction of the arrow (2).

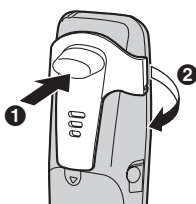

## Wall mounting

1 Drive the screws (not included) into the wall.

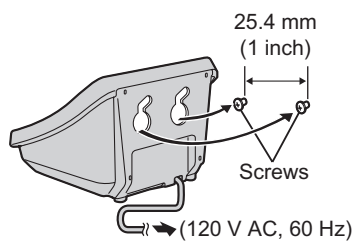

2 Mount the charger (1), then slide it down (2) and to the right (3) until it is secure.

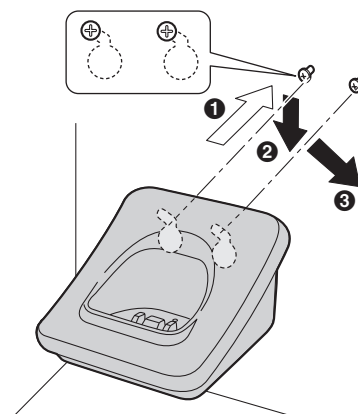

## Headset (optional)

Connecting a headset to the handset allows for hands-free phone conversations. We recommend using a Panasonic KX-TCA60/KX-TCA86/KX-TCA88HA/KX-TCA92/KX-TCA93/KX-TCA94/KX-TCA95 headset. See page 2 for ordering information.



- Headset shown is KX-TCA86.

## Specifications

### General

#### Operating environment:

5 °C – 40 °C (41 °F – 104 °F)

### Handset

#### Frequency:

5.74 GHz – 5.84 GHz

#### Dimensions:

Approx. height 156 mm × width 48 mm × depth 33 mm (6 <sup>1</sup>/<sub>8</sub> inches × 1 <sup>7</sup>/<sub>8</sub> inches × 1 <sup>5</sup>/<sub>16</sub> inches)

#### Mass (Weight):

Approx. 160 g (0.35 lb.)

#### Power output:

200 mW (max.)

#### Power supply:

Ni-MH battery (3.6 V, 650 mAh)

### Charger

#### Dimensions:

Approx. height 68 mm × width 82 mm × depth 87 mm (2 <sup>11</sup>/<sub>16</sub> inches × 3 <sup>7</sup>/<sub>32</sub> inches × 3 <sup>7</sup>/<sub>16</sub> inches)

#### Mass (Weight):

Approx. 80 g (0.18 lb.)

#### Power consumption:

Standby: Approx. 0.6 W

Maximum: Approx. 4.1 W

#### Power supply:

AC adaptor (120 V AC, 60 Hz)

#### Note:

- Design and specifications are subject to change without notice.
- The illustrations in these instructions may vary slightly from the actual product.

## Important safety instructions

### WARNING:

- To prevent the risk of fire or electrical shock, do not expose the product to rain or any type of moisture.
- Unplug the product from power outlets if it emits smoke, an abnormal smell, or makes an unusual noise. These conditions can cause fire or electric shock. Confirm that smoke has stopped emitting and contact the Panasonic Call Center at 1-800-211-PANA (1-800-211-7262).
- Do not place or use this product near automatically controlled devices such as automatic doors and fire alarms. Radio waves emitted from this product may cause such devices to malfunction resulting in an accident.
- Completely insert the AC adaptor/power plug into the power outlet. Failure to do so may cause electric shock and/or excessive heat resulting in a fire.
- Regularly remove any dust, etc. from the AC adaptor/power plug by pulling it from the power outlet, then wiping with a dry cloth. Accumulated dust may cause an insulation defect from moisture, etc. resulting in a fire.

### CAUTION:

#### Installation

- Operating the product near electrical appliances may cause interference. Move away from the electrical appliances.
- The AC adaptor is used as the main disconnect device. Ensure that the

AC outlet is installed near the product and is easily accessible.

### Battery

To reduce the risk of fire or injury to persons, read and follow these instructions.

- Use only the battery(ies) specified.
- Do not dispose of the battery(ies) in a fire, as they may explode. Check with local waste management codes for special disposal instructions.
- Do not open or mutilate the battery(ies). Released electrolyte is corrosive and may cause burns or injury to the eyes or skin. The electrolyte may be toxic if swallowed.
- Exercise care when handling the battery(ies). Do not allow conductive materials such as rings, bracelets or keys to touch the battery(ies), otherwise a short circuit may cause the battery(ies) and/or the conductive material to overheat and cause burns.
- Charge the battery(ies) provided, or identified for use with the product only, in accordance with the instructions and limitations specified in this manual.

---

## FCC and other information

This equipment is hearing aid compatible as defined by the FCC in 47 CFR Section 68.316.

When you hold the phone to your ear, noise might be heard in your Hearing Aid. Some Hearing Aids are not adequately shielded from external RF (radio frequency) energy. If noise occurs, use an optional headset accessory or the speakerphone option (if applicable) when using this phone. Consult with your audiologist or Hearing Aid manufacturer about the availability of Hearing Aids which provide adequate shielding to RF energy commonly emitted by digital devices.

### WHEN PROGRAMMING EMERGENCY NUMBERS AND(OR) MAKING TEST CALLS TO EMERGENCY NUMBERS:

- 1) Remain on the line and briefly explain to the dispatcher the reason for the call.
- 2) Perform such activities in the off-peak hours, such as early morning or late evenings.

This device complies with Part 15 of the FCC Rules. Operation is subject to the following two conditions:

(1) This device may not cause harmful interference, and (2) this device must accept any interference received, including interference that may cause undesired operation.

Privacy of communications may not be ensured when using this phone.

### CAUTION:

Any changes or modifications not expressly approved by the party responsible for compliance could void the user's authority to operate this device.

### NOTE:

This equipment has been tested and found to comply with the limits for a Class B digital device, pursuant to Part 15 of the FCC Rules. These limits are designed to provide reasonable protection against harmful interference in a residential installation. This equipment generates, uses, and can radiate radio frequency energy and, if not installed and used in accordance with the instructions, may cause harmful interference to radio communications. However, there is no guarantee that interference will not occur in a particular installation. If this equipment does cause harmful interference to radio or television reception, which can be determined by turning the equipment off and on, the user is encouraged to try to correct the interference by one or more of the following measures:

- Reorient or relocate the receiving antenna.
- Increase the separation between the equipment and receiver.
- Connect the equipment into an outlet on a circuit different from that to which the receiver is connected.
- Consult the dealer or an experienced radio/TV technician for help.



#### FCC RF Exposure Warning:

- This product complies with FCC radiation exposure limits set forth for an uncontrolled environment.
- This handset may not be collocated or operated in conjunction with any other antenna or transmitter.
- The handset may be carried and operated with only the specific provided belt-clip. Other non-tested belt-clips or similar body-worn accessories may not comply and must be avoided.

#### Notice

- This product is designed for use in the United States of America. Sale or use of this product in other countries may violate local laws.
- Cet appareil est conçu pour être utilisé aux États-Unis d'Amérique. La vente ou l'emploi de cet appareil dans certains autres pays peut constituer une infraction à la législation locale.
- Este producto está diseñado para usarse en los Estados Unidos de América. La venta o el empleo de este producto en ciertos países puede constituir violación de la legislación local.
- 本產品專為美國使用而設。若在其他國家銷售或使用，可能會違反當地法例。
- この製品は、日本国外での使用を目的として設計されており、日本国内での使用は法律違反となります。従って、当社では日本国内においては原則として修理などのサービスは致しかねます。

## Customer services

### joip customer support

joip is the VoIP service provided by deltathree, Inc. for this phone. If you cannot make or receive internet calls or if you are experiencing any other issues with your VoIP telephone services, please contact joip customer support:

- Visit [www.joip.com](http://www.joip.com) or send an email to [support@joip.com](mailto:support@joip.com)
- Call \*JOIP (\*5647) from your GLOBARANGE phone using the IP line.
- Call 1-877-NOW-JOIP (1-877-669-5647) using the landline.

In case of replacing your GLOBARANGE phone, you will need to contact joip Support Center in order to transfer your joip number and account information to the new phone.

You will not be able to use your joip account on the new phone unless you contact joip Support Center. For more information, please go to the Support section of the Member Center using your joip number and password at [www.joip.com](http://www.joip.com)

If you are experiencing any difficulty with your phone's functions or features, please contact Panasonic (page 10).

## **Panasonic customer service directory**

For your phone's functions or features, please contact Panasonic.

### ***Customer Services Directory***

Obtain Product Information and Operating Assistance; locate your nearest Dealer or Service Center; purchase Parts and Accessories; or make Customer Service and Literature requests by visiting our Web Site at:

**<http://www.panasonic.com/help>**

or, contact us via the web at:

**<http://www.panasonic.com/contactus>**

You may also contact us directly at: 1-800-211-PANA (1-800-211-7262),  
Monday - Friday 9 am to 9 pm; Saturday - Sunday 10 am to 7 pm, EST.

TTY users (hearing or speech impaired users) can call 1-877-833-8855.

### ***Accessory Purchases***

Purchase Parts, Accessories and Instruction Books online for all Panasonic Products by visiting our Web Site at:

**<http://www.pasc.panasonic.com>**

or, send your request by E-mail to:

**[npcparts@us.panasonic.com](mailto:npcparts@us.panasonic.com)**

You may also contact us directly at:

1-800-332-5368 (Phone) 1-800-237-9080 (Fax Only)

(Monday - Friday 9 am to 9 pm, EST.)

Panasonic Service and Technology Company

20421 84th Avenue South, Kent, WA 98032

(We Accept Visa, MasterCard, Discover Card, American Express, and  
Personal Checks.)

TTY users (hearing or speech impaired users) can call 1-866-605-1277.

### ***Service in Puerto Rico***

Panasonic Puerto Rico, Inc.

San Gabriel Industrial Park, Ave. 65 de Infantería, Km. 9.5,

Carolina, Puerto Rico 00985

Phone (787)750-4300, Fax (787)768-2910

---

---

## Warranty

**PANASONIC CONSUMER  
ELECTRONICS COMPANY, DIVISION  
OF PANASONIC CORPORATION OF  
NORTH AMERICA**  
One Panasonic Way,  
Secaucus, New Jersey 07094

**PANASONIC PUERTO RICO, INC.**  
San Gabriel Industrial Park,  
Ave. 65 de Infantería, Km. 9.5,  
Carolina, Puerto Rico 00985

## Panasonic Telephone Products Limited Warranty

### Limited Warranty Coverage

If your product does not work properly because of a defect in materials or workmanship, Panasonic Consumer Electronics Company or Panasonic Puerto Rico, Inc. (collectively referred to as "the warrantor") will, for the length of the period indicated on the chart below, which starts with the date of original purchase ("Limited Warranty period"), at its option either (a) repair your product with new or refurbished parts, or (b) replace it with a new or a refurbished product. The decision to repair or replace will be made by the warrantor.

<b>Parts</b>	<b>Labor</b>
<b>One (1) Year</b>	<b>One (1) Year</b>

During the "Labor" Limited Warranty period there will be no charge for labor. During the "Parts" Limited Warranty period, there will be no charge for parts. You must mail-in your product prepaid during the Limited Warranty period. This Limited Warranty excludes both parts and labor for batteries, antennas, and cosmetic parts (cabinet). This Limited Warranty only applies to products purchased and serviced in the United States or Puerto Rico. This Limited Warranty is extended only to the original purchaser and only covers products purchased as new.

### Mail-In Service

For assistance in the continental U.S.A. in obtaining repairs please ship the product prepaid to:

**Panasonic Service and Technology Company, Exchange Center,  
4900 George McVay Drive, Suite B Door #12, McAllen, TX 78503**  
[panacare@us.panasonic.com](mailto:panacare@us.panasonic.com)

When shipping the unit carefully pack, include all accessories, and send it prepaid, adequately insured and preferably in the original carton. Include a letter detailing the complaint, a return address and provide a day time phone number where you can be reached. A valid registered receipt is required under the 1 year parts and labor Limited Warranty.

For Limited Warranty service for headsets if a headset is included with this product please call Panasonic at 1-800-332-5368.

For assistance in Puerto Rico call Panasonic Puerto Rico, Inc. (787) 750-4300 or fax (787) 768-2910.

---

**For product assistance, visit [www.panasonic.com/help](http://www.panasonic.com/help)  
For joip assistance, visit [www.joip.com](http://www.joip.com)**

11

**IF REPAIR IS NEEDED DURING THE LIMITED WARRANTY PERIOD THE PURCHASER WILL BE REQUIRED TO FURNISH A SALES RECEIPT/PROOF OF PURCHASE INDICATING DATE OF PURCHASE, AMOUNT PAID AND PLACE OF PURCHASE. CUSTOMER WILL BE CHARGED FOR THE REPAIR OF ANY UNIT RECEIVED WITHOUT SUCH PROOF OF PURCHASE.**

**Limited Warranty Limits And Exclusions**

This Limited Warranty ONLY COVERS failures due to defects in materials or workmanship, and DOES NOT COVER normal wear and tear or cosmetic damage. The Limited Warranty ALSO DOES NOT COVER damages which occurred in shipment, or failures which are caused by products not supplied by the warrantor, or failures which result from accidents, misuse, abuse, neglect, bug infestation, mishandling, misapplication, alteration, faulty installation, set-up adjustments, misadjustment of consumer controls, improper maintenance, power line surge, lightning damage, modification, introduction of sand, humidity or liquids, commercial use such as hotel, office, restaurant, or other business or rental use of the product, or service by anyone other than a Factory Service Center or other Authorized Servicer, or damage that is attributable to acts of God.

**THERE ARE NO EXPRESS WARRANTIES EXCEPT AS LISTED UNDER "LIMITED WARRANTY COVERAGE". THE WARRANTOR IS NOT LIABLE FOR INCIDENTAL OR CONSEQUENTIAL DAMAGES RESULTING FROM THE USE OF THIS PRODUCT, OR ARISING OUT OF ANY BREACH OF THIS LIMITED WARRANTY.** (As examples, this excludes damages for lost time, lost calls or messages, cost of having someone remove or re-install an installed unit if applicable, travel to and from the servicer. The items listed are not exclusive, but are for illustration only.) **ALL EXPRESS AND IMPLIED WARRANTIES, INCLUDING THE WARRANTY OF MERCHANTABILITY, ARE LIMITED TO THE PERIOD OF THE LIMITED WARRANTY.**

Some states do not allow the exclusion or limitation of incidental or consequential damages, or limitations on how long an implied warranty lasts, so the exclusions may not apply to you.

This Limited Warranty gives you specific legal rights and you may also have other rights which vary from state to state. If a problem with this product develops during or after the Limited Warranty period, you may contact your dealer or Service Center. If the problem is not handled to your satisfaction, then write to the warrantor's Consumer Affairs Department at the addresses listed for the warrantor.

**PARTS AND SERVICE, WHICH ARE NOT COVERED BY THIS LIMITED WARRANTY, ARE YOUR RESPONSIBILITY.**

In the event that your unit requires service within or outside of the Limited Warranty, Panasonic will not be responsible for loss of ringtones or other information previously downloaded, including the cost to repurchase such ringtones or other information.

---

### ***If you need assistance with setup or operation***

joip is the VoIP service provided by deltathree, Inc. for this phone. If you cannot make or receive internet calls or if you are experiencing any other issues with your VoIP telephone services, please contact joip customer support (page 9). If you are experiencing any difficulty with your phone's functions or features, please contact Panasonic as follows.

- 1** Visit our website: <http://www.panasonic.com/help>
- 2** Contact us via the web at: <http://www.panasonic.com/contactus>
- 3** Call us at: 1-800-211-PANA (1-800-211-7262)  
TTY users (hearing or speech impaired users) can call 1-877-833-8855.

### **When you ship the product**

- Carefully pack your unit, preferably in the original carton.
- Attach a letter, detailing the symptom, to the outside of the carton.
- Send the unit to Panasonic Service and Technology Company, Exchange Center, prepaid and adequately insured.
- Do not send your unit to Panasonic Consumer Electronics Company listed below or to executive or regional sales offices. These locations do not repair consumer products.

**Panasonic Consumer Electronics Company,  
Division of Panasonic Corporation of North America**  
One Panasonic Way, Secaucus, New Jersey 07094

**Panasonic Puerto Rico, Inc.**  
San Gabriel Industrial Park, Ave. 65 de Infantería, Km. 9.5,  
Carolina, Puerto Rico 00985

### **Copyright:**

This material is copyrighted by Panasonic Communications Co., Ltd., and may be reproduced for internal use only. All other reproduction, in whole or in part, is prohibited without the written consent of Panasonic Communications Co., Ltd.  
© 2007 Panasonic Communications Co., Ltd. All Rights Reserved.

# Panasonic®

## Manual de instalación

Powered by  
delkathree, Inc. **joip™**

Teléfono VoIP (Internet) inalámbrico Global

Modelo N° **BB-GTA150**

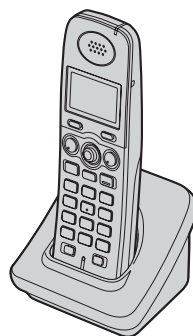

**5.8GHz**  
DIGITAL CORDLESS PHONE

**GLOBARANGE**  
globarange.com

**Gracias por adquirir un teléfono inalámbrico Panasonic.**

Este auricular es un auricular accesorio para usarse con las unidades BB-GT1500/BB-GT1540 de Panasonic. Debe registrar este auricular con su unidad base antes de poder usarlo.

Este manual de instalación sólo describe los pasos necesarios para registrar y comenzar a usar el auricular. Lea las instrucciones de operación de la unidad base para obtener mayores detalles.

**Cargue la batería durante 7 horas antes de utilizarla por primera vez.**

Lea este manual de instalación antes de usar la unidad y guárdelo para consultarlo en el futuro.

## Información de los accesorios

### Accesorios incluidos

Accesorio	Número de pedido	Cantidad
Cargador	PQLV30054PB	1
Adaptador de corriente para el cargador	PQLV208	1
Batería	HHR-P107	1
Tapa del auricular*1	PQYNGTA150BR	1
Gancho para el cinturón	PQKE10478Z2	1

\*1 La cubierta del auricular viene unida a él.

### Información de ventas y respaldo

- Para pedir accesorios de repuesto, llame al 1-800-332-5368.
- Los usuarios TTY (usuarios con impedimentos auditivos o del habla) pueden llamar al 1-866-605-1277.

## Instalación del auricular

### Conexión del cargador

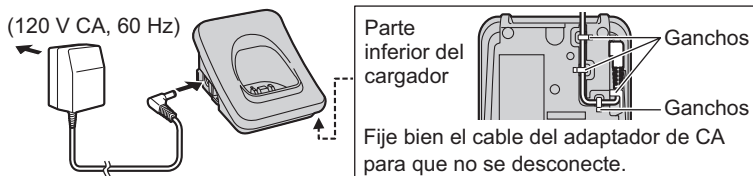

#### Nota:

- Use sólo el adaptador de corriente Panasonic PQLV208 incluido.
- El adaptador de corriente debe permanecer conectado todo el tiempo. (Es normal que el adaptador se caliente durante su uso.)
- El adaptador de corriente debe estar conectado a un enchufe de corriente orientado verticalmente o en una toma de corriente alterna montada en el piso. No conecte el adaptador de corriente alterna a una toma de corriente montada en el techo, ya que el peso del adaptador puede hacer que se desconecte.

### Instalación de la batería

- 1 Oprima firmemente el seguro de la cubierta del auricular y deslícelo en dirección de la flecha.

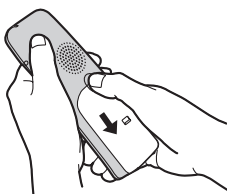

- 2 Inserte la batería (1), y presiónela hasta que encaje en el compartimiento (2). Después, cierre la cubierta del auricular (3, 4).

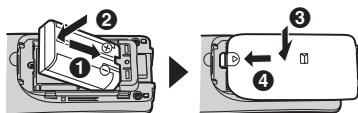

### Carga de la batería

Coloque el auricular en el cargador durante **7 horas** antes de usarlo por primera vez.

- Mientras se carga, el indicador de carga del auricular se ilumina en color ámbar. Cuando la batería está completamente cargada, el indicador se ilumina en verde.



#### Nota:

- Si desea utilizar el auricular de inmediato, cargue la batería durante un mínimo de 15 minutos.
- Para asegurarse de que la batería se cargue correctamente, limpie los contactos de carga del auricular y el cargador con un paño suave y seco una vez al mes. Límpielos con mayor frecuencia si la unidad está sujeta a grasa, polvo o un alto nivel de humedad.



**Rendimiento de la batería Panasonic**

Operación	Tiempo de funcionamiento
Mientras esté en uso (hablando)	Hasta 6 horas
Mientras no esté en uso (en espera)	Hasta 14 días
Mientras use la función de amplificador de claridad	Hasta 4 horas

**Nota:**

- El auricular se puede dejar en el cargador sin que esto dañe la batería.
- Es posible que el nivel de la batería no se muestre correctamente después de que la reemplace. En este caso, coloque el auricular en el cargador y permita que se cargue durante 7 horas.

**Registro**

Registre el auricular en una unidad base BB-GT1500/BB-GT1540.

**1 Unidad base:****BB-GT1500**

Oprima y mantenga oprimido **[HANDSET LOCATOR]** hasta que el indicador de STATUS parpadee en rojo.

**BB-GT1540**

Oprima y mantenga oprimido **[LOCATOR]** hasta que suene el tono de registro y el indicador de STATUS parpadee en rojo.

- Si todos los auriculares registrados comienzan a timbrar, deténgalos oprimiendo el mismo botón. Después repita este paso.
- Después de que el indicador de STATUS comience a parpadear en rojo, debe completar el resto del procedimiento en menos de 90 segundos.

**2 Auricular:****[OK ↵]**

- Cuando el auricular se haya registrado con éxito, **Y** cambiará a **Y**.

**Para cambiar el idioma de la pantalla**

- 1 [OFF] → [MENU] → [≡][1][1][0]**
- 2 [↕]/[▲]:** Seleccione la configuración deseada.
- 3 Oprima hacia abajo el centro del joystick para guardar. → [OFF]**

## Gancho para el cinturón

Puede colgarse el auricular en el cinturón o bolsillo usando el gancho para el cinturón que se incluye.

### Para colocar el gancho para el cinturón

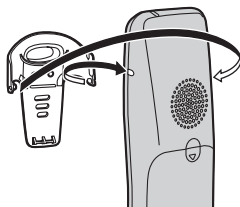

### Para quitar el gancho para el cinturón

Mientras oprime la parte superior del gancho (1), jale la orilla derecha en la dirección de la flecha (2).

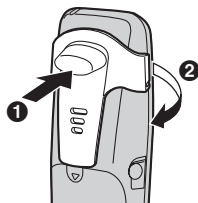

## Montaje en la pared

1 Inserte los tornillos (no incluidos) en la pared.

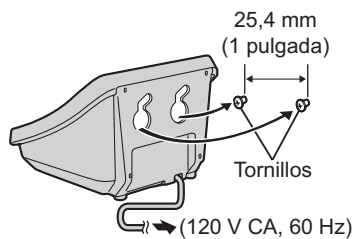

2 Monte el cargador (1) y deslícelo hacia abajo (2) y a la derecha (3) hasta que quede bien asegurado.

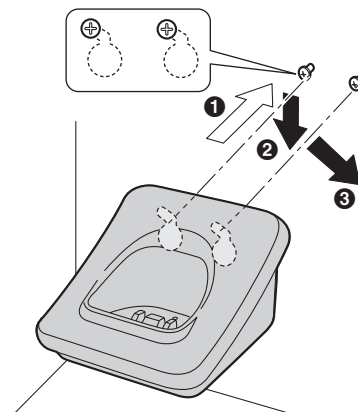

## Audífono (opcional)

La conexión de un audífono al auricular permite tener conversaciones a manos libres. Recomendamos que utilice sólo un audífono Panasonic de los siguientes modelos: KX-TCA60/KX-TCA86/KX-TCA88HA/KX-TCA92/KX-TCA93/KX-TCA94/KX-TCA95. Consulte la página 2 para obtener información sobre pedidos.



- El audífono que se muestra es el KX-TCA86.

## Especificaciones

### General

#### Entorno de operación:

5 °C – 40 °C (41 °F – 104 °F)

### Auricular

#### Frecuencia:

5.74 GHz – 5.84 GHz

#### Dimensiones:

Aprox. 156 mm de alto × 48 mm de ancho × 33 mm de profundidad (6 <sup>1</sup>/<sub>8</sub> pulgadas × 1 <sup>7</sup>/<sub>8</sub> pulgadas × 1 <sup>5</sup>/<sub>16</sub> pulgadas)

#### Peso:

Aprox. 160 g (0.35 lbs.)

#### Potencia de salida:

200 mW (máx.)

#### Suministro eléctrico:

Batería de Ni-MH (3.6 V, 650 mAh)

### Cargador

#### Dimensiones:

Aprox. 68 mm de alto × 82 mm de ancho × 87 mm de profundidad (2 <sup>11</sup>/<sub>16</sub> pulgadas × 3 <sup>7</sup>/<sub>32</sub> pulgadas × 3 <sup>7</sup>/<sub>16</sub> pulgadas)

#### Peso:

Aprox. 80 g (0.18 lbs.)

#### Consumo de energía:

En espera: Aprox. 0.6 W

Máximo: Aprox. 4.1 W

#### Suministro eléctrico:

Adaptador para corriente (120 V CA, 60 Hz)

#### Nota:

- El diseño y especificaciones están sujetos a cambio sin previo aviso.
- Las ilustraciones de estas instrucciones pueden ser ligeramente diferentes al producto.